















Handwritten text in Indonesian script, appearing to be a list or notes, mostly illegible due to fading and bleed-through.

Milik & Belarismo  
Kramatjati no 1  
Jakarta  
pejak 1970

*[Signature]*

Seberahkan kepada  
Perpustakaan Nasional

tgl 13/4 1980

*[Signature]*



86

No 11

No 12

No 13

Handwritten text in a cursive script, likely a historical document or manuscript. The text is arranged in several lines, with some words appearing to be in a different script or dialect. The text is partially obscured by a large, faint watermark or stamp in the center of the page, which appears to be a circular emblem with some text or a figure inside. The handwriting is dense and somewhat difficult to decipher due to the cursive style and the watermark.

No 14

No 15

No 16



Handwritten text in Burmese script, arranged in approximately 15 horizontal lines. The text is written in a cursive style and is partially obscured by a large, semi-transparent watermark in the center of the page. The watermark features a circular emblem with a central figure and surrounding text. The Burmese characters are densely packed and flow across the lines. At the top and bottom of the page, there are several large, stylized characters that appear to be initials or section markers, possibly '၇၈' (78) at the top left and right, and '၇၉' (79) at the bottom left and right.



M13. 79

Bezoek vlaggen Binn: II



( Babad Manghuban )  
L<sup>7</sup>  
8

hi  
29 juni 89

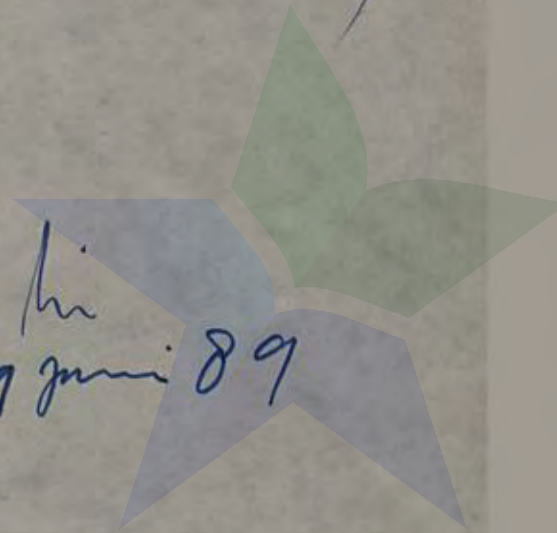







Handwritten Burmese script, likely a historical document or manuscript. The text is densely packed and written in a cursive style. It appears to be a collection of lines or paragraphs, possibly containing names, titles, or official records. The script is characteristic of traditional Burmese writing.



Handwritten text at the top of the page, possibly a title or header.

Main body of handwritten text, consisting of multiple lines of cursive script.



Handwritten Burmese script, likely a religious or historical text, written in a cursive style. The text is arranged in approximately 25 horizontal lines across the page. The script is dense and characteristic of traditional Burmese calligraphy. There are several instances of double-line underlines (double bars) used as section markers or for emphasis. The text is written in black ink on aged, slightly yellowed paper. A faint, light-colored watermark or stamp is visible in the lower right quadrant of the page, partially overlapping the text.







Handwritten text in a cursive script, likely a historical document or manuscript. The text is densely packed and spans the entire page. It appears to be a list or a series of entries, possibly related to a collection or inventory. The script is highly stylized and difficult to decipher without specialized knowledge of the language or dialect used. The text is written in dark ink on aged, slightly yellowed paper. There are some faint markings and a small tear at the top right corner of the page.







Handwritten text in a cursive script, likely a historical document or manuscript. The text is written in a dark ink on aged, yellowish paper. The script is dense and fills most of the page, with some lines appearing to be part of a list or a series of entries. The handwriting is somewhat slanted and consistent throughout, suggesting a single scribe. There are some faint markings and shadows on the page, possibly from the binding or the way the document was stored.















Handwritten text in a cursive script, likely a list or index. The text is written in a dark ink on aged paper. The entries are organized into columns, with some entries starting with a double quote symbol. The handwriting is dense and somewhat difficult to decipher due to the cursive style and the angle of the page. The text appears to be a list of names or titles, possibly related to a collection or a library. The entries are arranged in a somewhat regular pattern, with some entries being longer than others. The overall appearance is that of a historical document or a manuscript.







Handwritten text in a cursive script, likely a historical document or manuscript. The text is written in a dark ink on aged paper and is oriented vertically, reading from top to bottom. The script is highly stylized and difficult to decipher. The text is arranged in approximately 20 horizontal lines, with some lines containing multiple columns of writing. The overall appearance is that of a dense, handwritten record or account.







Handwritten text in a cursive script, likely a historical document or manuscript. The text is densely packed and spans the entire page. It appears to be a list or a series of entries, possibly related to a collection or inventory. The script is highly stylized and difficult to decipher without specialized knowledge of the language and script.







„Wohlstand“ „Wohlstand“ „Wohlstand“ „Wohlstand“ „Wohlstand“

„Wohlstand“ „Wohlstand“ „Wohlstand“ „Wohlstand“ „Wohlstand“

„Wohlstand“ „Wohlstand“ „Wohlstand“ „Wohlstand“ „Wohlstand“

„Wohlstand“ „Wohlstand“ „Wohlstand“ „Wohlstand“ „Wohlstand“

„Wohlstand“ „Wohlstand“ „Wohlstand“ „Wohlstand“ „Wohlstand“

„Wohlstand“ „Wohlstand“ „Wohlstand“ „Wohlstand“ „Wohlstand“

„Wohlstand“ „Wohlstand“ „Wohlstand“ „Wohlstand“ „Wohlstand“

„Wohlstand“ „Wohlstand“ „Wohlstand“ „Wohlstand“ „Wohlstand“

„Wohlstand“ „Wohlstand“ „Wohlstand“ „Wohlstand“ „Wohlstand“







Handwritten text in a cursive script, likely a historical document or manuscript. The text is densely packed and spans the entire page. It appears to be a list or a series of entries, possibly related to a collection or inventory. The script is highly stylized and difficult to decipher without specialized knowledge of the language and script. The text is written in a dark ink on aged, slightly yellowed paper. There are some faint markings and a large, light-colored smudge or stain in the center of the page, which partially obscures some of the text. The overall appearance is that of an old, well-used manuscript.















Handwritten text in a cursive script, likely a historical document or manuscript. The text is arranged in approximately 20 horizontal lines, written from right to left. The script is dense and characteristic of early modern European cursive. The document appears to be a list or a series of entries, with many lines starting with a double quote symbol (") and ending with a period. The text is somewhat faded and difficult to decipher due to the cursive style and the age of the paper. There are some faint markings and a large, irregular stain in the center of the page, possibly from a watermark or a physical mark on the original document.







Handwritten text in a cursive script, likely a historical document or manuscript. The text is arranged in approximately 20 horizontal lines, written from right to left. The script is dense and characteristic of early modern European cursive. There are several instances of double quotation marks (") used throughout the text, possibly indicating specific terms or phrases. The paper shows signs of age, including some staining and a large, faint green watermark or stain in the center-right area. The text is written in dark ink on a light-colored, slightly textured paper.







Handwritten text in a cursive script, likely a historical document or manuscript. The text is written in a dark ink on aged paper and is arranged in approximately 25 horizontal lines. The script is highly stylized and difficult to decipher. A large, semi-transparent watermark is visible in the center of the page, featuring a blue and green design that partially obscures the underlying text. The watermark appears to be a logo or emblem, possibly related to a library or archival institution. The overall appearance is that of an old, handwritten document with a significant watermark overlay.



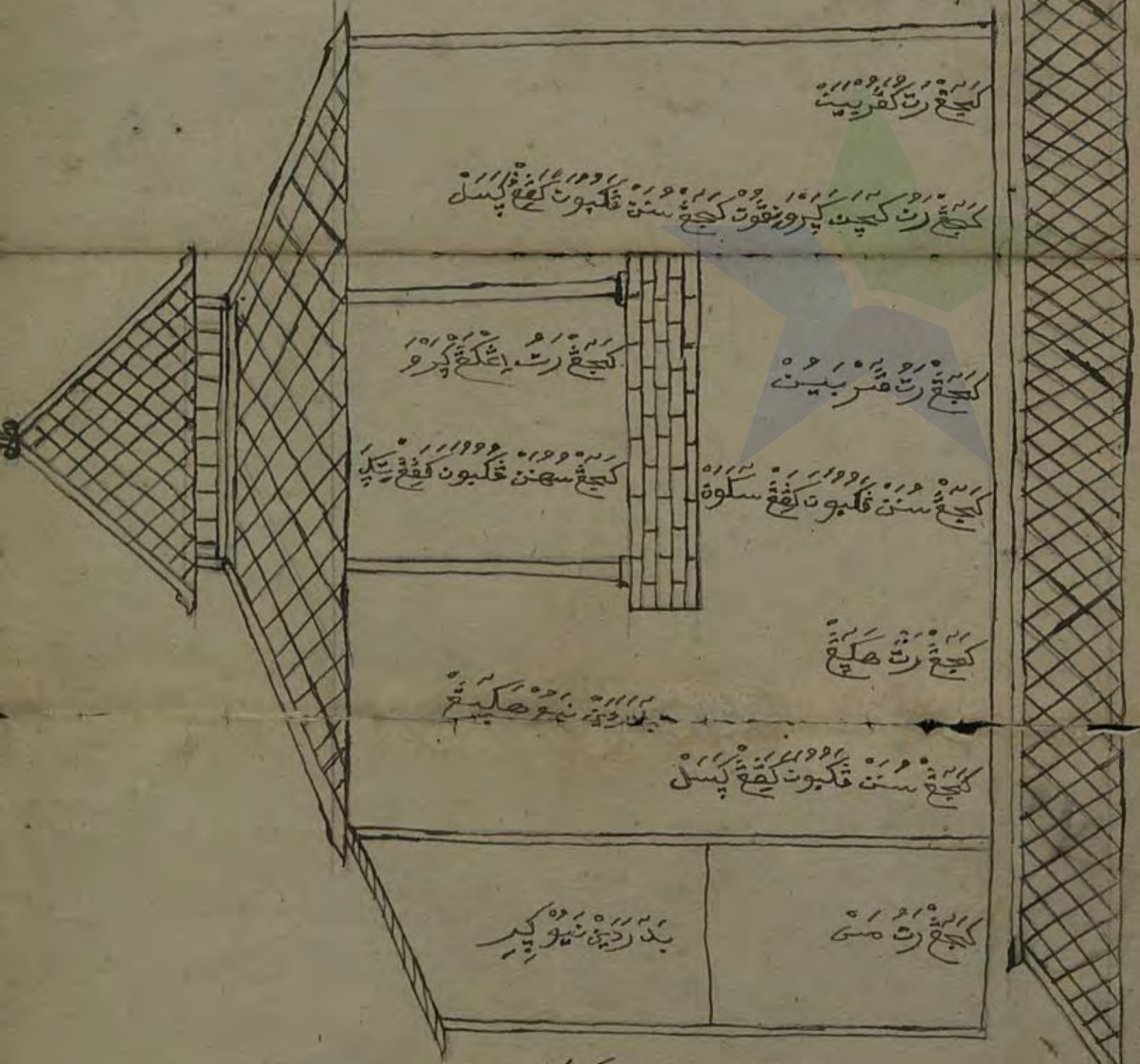
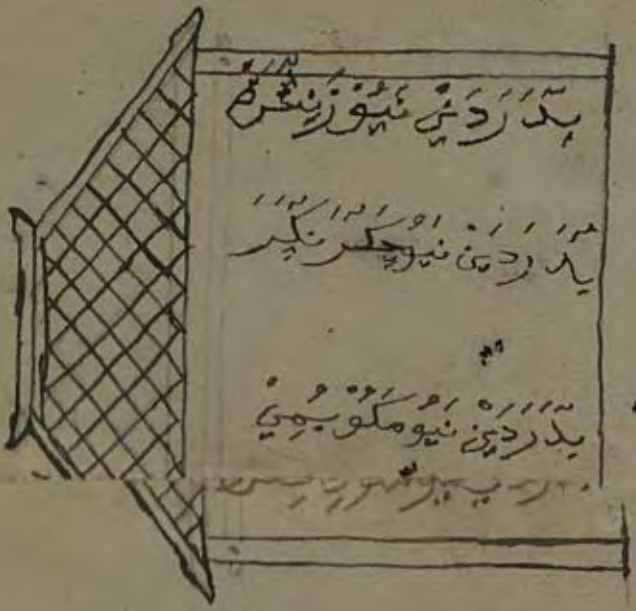







Handwritten text in a cursive script, likely a historical document or manuscript. The text is written in a dark ink on aged paper and is arranged in approximately 20 horizontal lines. The script is highly stylized and difficult to decipher. The document contains several lines of text, some of which are enclosed in double quotation marks. The text appears to be a collection of phrases or a short narrative, possibly related to a historical event or a personal account. The overall appearance is that of an old, handwritten manuscript.







Handwritten text in a cursive script, likely a historical document or manuscript. The text is densely packed and spans the entire page. It appears to be a list or a series of entries, possibly related to a collection or inventory. The script is highly stylized and difficult to decipher without specialized knowledge of the language or dialect used. The text is written in dark ink on aged, slightly yellowed paper. There are some faint markings and a large, light-colored smudge or stain in the lower right quadrant of the page.















Handwritten text in a cursive script, likely a historical document or manuscript. The text is written in a dark ink on aged, slightly yellowed paper. The script is dense and fills most of the page, with some lines appearing to be part of a list or a series of entries. The handwriting is characteristic of the 17th or 18th century. There are some faint markings and a large, light-colored smudge or stain in the center-right area of the page, which partially obscures some of the text. The overall appearance is that of an old, well-used document.







Handwritten text in a cursive script, likely a historical document or manuscript. The text is written in a dark ink on aged paper and is arranged in approximately 25 horizontal lines. The script is highly stylized and difficult to decipher. A large, semi-transparent watermark is visible in the center of the page, featuring a circular emblem with a crown and a shield, surrounded by text. The watermark is oriented vertically and appears to be a modern addition to the document.







Handwritten text in a cursive script, likely a historical document or manuscript. The text is written in a dark ink on aged, slightly yellowed paper. The script is dense and fills most of the page, with some lines appearing to be part of a list or a series of entries. The handwriting is characteristic of the 17th or 18th century. There are some faint markings and a large, light-colored smudge or stain in the lower right quadrant of the page.



๗๓๐  
 ๗๓๑  
 ๗๓๒  
 ๗๓๓  
 ๗๓๔  
 ๗๓๕  
 ๗๓๖  
 ๗๓๗  
 ๗๓๘  
 ๗๓๙  
 ๗๔๐  
 ๗๔๑  
 ๗๔๒  
 ๗๔๓  
 ๗๔๔  
 ๗๔๕  
 ๗๔๖  
 ๗๔๗  
 ๗๔๘  
 ๗๔๙  
 ๗๕๐  
 ๗๕๑  
 ๗๕๒  
 ๗๕๓  
 ๗๕๔  
 ๗๕๕  
 ๗๕๖  
 ๗๕๗  
 ๗๕๘  
 ๗๕๙  
 ๗๖๐  
 ๗๖๑  
 ๗๖๒  
 ๗๖๓  
 ๗๖๔  
 ๗๖๕  
 ๗๖๖  
 ๗๖๗  
 ๗๖๘  
 ๗๖๙  
 ๗๗๐  
 ๗๗๑  
 ๗๗๒  
 ๗๗๓  
 ๗๗๔  
 ๗๗๕  
 ๗๗๖  
 ๗๗๗  
 ๗๗๘  
 ๗๗๙  
 ๗๘๐  
 ๗๘๑  
 ๗๘๒  
 ๗๘๓  
 ๗๘๔  
 ๗๘๕  
 ๗๘๖  
 ๗๘๗  
 ๗๘๘  
 ๗๘๙  
 ๗๙๐  
 ๗๙๑  
 ๗๙๒  
 ๗๙๓  
 ๗๙๔  
 ๗๙๕  
 ๗๙๖  
 ๗๙๗  
 ๗๙๘  
 ๗๙๙  
 ๘๐๐



Handwritten text in a cursive script, likely a historical document or manuscript. The text is written in a dark ink on aged paper and is arranged in approximately 25 horizontal lines. The script is highly stylized and difficult to decipher. A large, semi-transparent watermark is visible in the center of the page, featuring a five-pointed star or starburst shape. The watermark is light blue and green, and it partially obscures the underlying text. The text appears to be a list or a series of entries, with some lines starting with a double quote symbol. The overall appearance is that of an old, handwritten document.







Handwritten text in a cursive script, likely a historical document or manuscript. The text is written in a dark ink on aged paper and is arranged in approximately 25 horizontal lines. The script is highly stylized and difficult to decipher. A large, semi-transparent watermark is visible in the center of the page, featuring a circular emblem with a crown and a shield, surrounded by text. The watermark is oriented vertically and appears to be a modern addition to the document.







Handwritten text in a cursive script, likely a historical document or manuscript. The text is written in a dark ink on aged, slightly yellowed paper. It consists of approximately 25 lines of text, arranged in a single column. The script is highly stylized and difficult to decipher without specialized knowledge of the language. The text appears to be a list or a series of entries, possibly related to a historical record or a collection of names. The lines are closely spaced, and the overall appearance is that of a dense, handwritten document. There are some faint markings and a small blue stain on the right side of the page, which may be related to the document's history or the scanning process.







Handwritten text in a cursive script, likely a list or index, written on aged paper. The text is arranged in approximately 25 horizontal lines, with some lines containing multiple entries separated by double slashes (//). The script is dense and difficult to decipher due to its cursive nature and the fading of the ink. A large, semi-transparent watermark is visible in the center of the page, partially obscuring the text. The watermark appears to be a circular emblem or logo, but its details are not clearly legible. The overall appearance is that of an old, handwritten document, possibly a manuscript or a collection of notes.







Handwritten text in a cursive script, likely a list or a series of entries. The text is written in a dark ink on aged paper. It begins with a large initial letter, possibly 'A', and continues with several lines of text. The script is dense and somewhat difficult to decipher due to its cursive nature. There are some faint markings and a small red mark near the top right of the page.

Handwritten text in a cursive script, continuing from the previous block. The text is written in a dark ink on aged paper. It begins with a large initial letter, possibly 'B', and continues with several lines of text. The script is dense and somewhat difficult to decipher due to its cursive nature. There are some faint markings and a small red mark near the top right of the page.







Handwritten text in a cursive script, likely a historical document or manuscript. The text is written in a dark ink on aged paper and is arranged in approximately 25 horizontal lines. The script is highly stylized and difficult to decipher. A large, semi-transparent watermark is visible in the center of the page, featuring a circular emblem with a crown and a shield, surrounded by text. The watermark is oriented vertically and appears to be a logo for a library or archival institution. The overall appearance is that of an old, possibly Latin or German, manuscript page.















Handwritten text in a cursive script, likely a historical document or manuscript. The text is written in a dark ink on aged paper and is oriented vertically. The script is dense and difficult to decipher due to its cursive nature and the angle of the page. The text appears to be a list or a series of entries, possibly related to a historical record or a collection of items. The words are written in a highly stylized, flowing manner, characteristic of 17th or 18th-century handwriting. The overall appearance is that of a well-preserved but challenging-to-read historical document.















Handwritten Burmese text, likely a manuscript or record, written in a cursive style. The text is arranged in approximately 25 horizontal lines across the page. The script is dense and characteristic of traditional Burmese calligraphy. The content appears to be a list or a series of entries, possibly related to administrative or historical records. The text is written in black ink on aged, slightly yellowed paper. There are some faint markings and a large, light-colored smudge or stain in the center-right area of the page, which partially obscures some of the text. The overall appearance is that of an old, well-used document.







Handwritten text in a cursive script, likely a historical document or manuscript. The text is written in a dark ink on aged paper and is oriented vertically. It consists of approximately 25 lines of text, with some lines starting with a double quote symbol. The script is dense and difficult to decipher due to its cursive nature and the angle of the page. The text appears to be a list or a series of entries, possibly related to a historical record or a collection of names. The paper shows signs of age, including some discoloration and a faint watermark or stain in the center.















Handwritten text in a cursive script, likely a historical document or manuscript. The text is written in a dark ink on aged paper and is oriented vertically, reading from top to bottom. The script is highly stylized and difficult to decipher. The document contains approximately 25 lines of text, with some lines starting with a small symbol or initial. The text is densely packed and covers most of the page area.







Handwritten text in a cursive script, likely a historical document or manuscript. The text is written in a dark ink on aged paper and is oriented vertically. It consists of approximately 20 lines of text, with some lines starting with a double quote symbol. The script is highly stylized and difficult to decipher without specialized knowledge of the language and handwriting. The text appears to be a list or a series of entries, possibly related to a historical record or a collection of names. The overall appearance is that of an old, handwritten document.







Handwritten text in a cursive script, likely a historical document or manuscript. The text is densely packed and spans the entire page. It appears to be a list or a series of entries, possibly related to a collection or inventory. The script is highly stylized and difficult to decipher without specialized knowledge of the language or dialect used. The text is written in dark ink on aged, slightly yellowed paper. There are some faint markings and a small blue rectangular mark near the center of the page.



(Handwritten text in a cursive script, likely a historical document or manuscript. The text is dense and spans most of the page, with some lines appearing to be part of a list or a series of entries. The script is highly stylized and difficult to decipher without specialized knowledge of the language.)



Handwritten text in a cursive script, likely a historical document or manuscript. The text is written in a dark ink on aged, slightly yellowed paper. It consists of approximately 25 lines of text, arranged in a single column. The script is highly stylized and difficult to decipher without specialized knowledge of the language. The text appears to be a list or a series of entries, with some lines starting with a double quote symbol. The overall appearance is that of a historical record or a collection of notes.







Handwritten text in a cursive script, likely a historical document or manuscript. The text is written in a dark ink on aged paper and is arranged in approximately 25 horizontal lines. The script is highly stylized and difficult to decipher without specialized knowledge of the language or dialect. The document appears to be a formal record or a personal letter, given the structured nature of the lines and the use of some punctuation marks like commas and periods. The paper shows signs of age, including slight discoloration and a faint watermark or stamp in the center-right area.















Handwritten text in a cursive script, likely a historical document or manuscript. The text is written in a dark ink on aged paper and is oriented vertically. The script is dense and difficult to decipher due to its cursive nature and the angle of the page. The text appears to be organized into several lines or paragraphs, with some lines starting with a double quote symbol. The overall appearance is that of a historical record or a collection of notes.







Handwritten text in a cursive script, likely a historical document or manuscript. The text is written in a dark ink on aged, slightly yellowed paper. It consists of approximately 25 lines of text, with some lines starting with a double quote symbol. The script is dense and difficult to decipher due to its cursive nature and the fading of the ink. The text appears to be a collection of phrases or a short narrative, possibly related to a historical event or a personal account. The overall appearance is that of an old, well-preserved manuscript page.















Handwritten text in a cursive script, likely a historical document or manuscript. The text is written in a dark ink on aged paper and is oriented vertically. The script is highly stylized and difficult to decipher. The text is arranged in approximately 25 lines, with some lines starting with a large initial letter. The overall appearance is that of a formal or official document from a past era.







Handwritten text in a cursive script, likely a historical document or manuscript. The text is densely packed and spans the entire page. A large, light-colored watermark or stamp is visible in the center-right area, partially obscuring the text. The script is highly stylized and difficult to decipher without specialized knowledge of the language and script.







Handwritten text in a cursive script, likely a historical document or manuscript. The text is written in a dark ink on aged paper. It begins with a large initial letter, possibly 'A' or 'B', and continues with several lines of dense, flowing script. The text is somewhat difficult to decipher due to the cursive style and the age of the document.

Handwritten text in a cursive script, continuing from the previous block. The text is written in a dark ink on aged paper. It begins with a large initial letter, possibly 'C' or 'D', and continues with several lines of dense, flowing script. The text is somewhat difficult to decipher due to the cursive style and the age of the document. There are some faint markings and a large, irregular shape (possibly a stain or a piece of tape) on the right side of the page, partially overlapping the text.







Handwritten text in a cursive script, likely Burmese, covering the entire page. The text is densely packed and appears to be a continuous narrative or list of entries. The script is highly stylized and difficult to decipher without specialized knowledge of the language. The text is written in dark ink on aged, slightly yellowed paper. There are some faint markings and a large, light-colored smudge or stain on the right side of the page, partially obscuring the text.







Handwritten text in a cursive script, likely a historical document or manuscript. The text is written in a dark ink on aged paper and is arranged in approximately 25 horizontal lines. The script is highly stylized and difficult to decipher, but it appears to be a form of early modern European cursive. The document contains various words and phrases, some of which are enclosed in double quotation marks. The overall appearance is that of a formal or legal document from the 16th or 17th century.







Handwritten text in a cursive script, likely a historical document or manuscript. The text is written in a dark ink on aged paper. It consists of approximately 15 lines of text, with some lines starting with a double quote symbol. The script is dense and difficult to decipher due to its cursive nature and the age of the document. The text appears to be a list or a series of entries, possibly related to a collection or inventory.

Handwritten text in a cursive script, continuing from the previous block. It consists of approximately 5 lines of text, with some lines starting with a double quote symbol. The script is dense and difficult to decipher due to its cursive nature and the age of the document. The text appears to be a list or a series of entries, possibly related to a collection or inventory.







Handwritten text in a cursive script, likely a historical document or manuscript. The text is written in a dark ink on aged paper and is arranged in approximately 25 horizontal lines. The script is highly stylized and difficult to decipher without specialized knowledge of the language or dialect. The document appears to be a formal record or a collection of entries, possibly related to land ownership or administrative matters, given the repetitive nature of some phrases and the use of what might be titles or names. The text is densely packed and covers most of the page area.







Handwritten text in a cursive script, likely a historical document or manuscript. The text is written in a dark ink on aged paper and is oriented vertically, reading from top to bottom. The script is highly stylized and difficult to decipher. The document contains several lines of text, with some words appearing to be in a different language or dialect than the surrounding text. There are some faint markings and a large, light-colored smudge or stain in the center of the page, which partially obscures the text. The overall appearance is that of an old, handwritten document.







Handwritten text in a cursive script, likely a historical document or manuscript. The text is written in a dark ink on aged paper and is arranged in approximately 25 horizontal lines. The script is highly stylized and difficult to decipher without specialized knowledge of the language or dialect. The document appears to be a formal record or a collection of entries, possibly related to land ownership or administrative matters, given the repetitive nature of some phrases and the use of what might be titles or identifiers. The text is densely packed and covers most of the page area.







Handwritten Burmese script, likely a religious or historical text, written in a cursive style. The text is arranged in approximately 20 horizontal lines across the page. The characters are dark and densely packed, with some lines showing clear punctuation marks such as double slashes (//) and vertical bars (|). The script is characteristic of traditional Burmese calligraphy used in manuscripts.







Handwritten text in a cursive script, likely a historical document or manuscript. The text is written in a dark ink on aged paper and is arranged in approximately 25 horizontal lines. The script is dense and difficult to decipher due to its cursive nature and the fading of the ink. The document appears to be a formal record or a set of instructions, given the structured layout and the use of what might be initials or specific terms. The text is written from left to right, following the traditional orientation of the page.























Handwritten text at the top of the page, possibly a title or header.

Main body of handwritten text, consisting of approximately 20 lines of dense, cursive script.







Handwritten text in a cursive script, likely a historical document or manuscript. The text is written in a dark ink on aged, slightly yellowed paper. The script is dense and fills most of the page, with some lines starting with a double quote symbol. The text is oriented vertically, reading from top to bottom. There are some faint markings and a large, light-colored smudge or stain in the middle-right portion of the page, which partially obscures some of the handwriting. The overall appearance is that of an old, handwritten record or letter.







Handwritten text in a cursive script, likely a historical document or manuscript. The text is densely packed and spans the entire page. It appears to be a list or a series of entries, possibly related to a collection or inventory. The script is highly stylized and difficult to decipher without specialized knowledge of the language or dialect used. The text is written in dark ink on aged, slightly yellowed paper. There are some faint markings and a large, light-colored smudge or stain in the center of the page, which partially obscures some of the text. The overall appearance is that of an old, well-used document.







Handwritten text in a cursive script, likely a historical document or manuscript. The text is densely packed and spans most of the page.

Handwritten text in a cursive script, continuing from the previous block. It appears to be a separate section or a continuation of the same document.







၁။ အဘယ့်ကြောင့် နေ့စဉ် နေထိုင်ရာ အလုပ်အကိုင်များကို စိတ်ချစွာ ပြုလုပ်နိုင်ရန် အရေးကြီးသည်။  
 ၂။ အလုပ်အကိုင်များကို စိတ်ချစွာ ပြုလုပ်နိုင်ရန် အရေးကြီးသည်။  
 ၃။ အလုပ်အကိုင်များကို စိတ်ချစွာ ပြုလုပ်နိုင်ရန် အရေးကြီးသည်။  
 ၄။ အလုပ်အကိုင်များကို စိတ်ချစွာ ပြုလုပ်နိုင်ရန် အရေးကြီးသည်။  
 ၅။ အလုပ်အကိုင်များကို စိတ်ချစွာ ပြုလုပ်နိုင်ရန် အရေးကြီးသည်။  
 ၆။ အလုပ်အကိုင်များကို စိတ်ချစွာ ပြုလုပ်နိုင်ရန် အရေးကြီးသည်။  
 ၇။ အလုပ်အကိုင်များကို စိတ်ချစွာ ပြုလုပ်နိုင်ရန် အရေးကြီးသည်။  
 ၈။ အလုပ်အကိုင်များကို စိတ်ချစွာ ပြုလုပ်နိုင်ရန် အရေးကြီးသည်။  
 ၉။ အလုပ်အကိုင်များကို စိတ်ချစွာ ပြုလုပ်နိုင်ရန် အရေးကြီးသည်။  
 ၁၀။ အလုပ်အကိုင်များကို စိတ်ချစွာ ပြုလုပ်နိုင်ရန် အရေးကြီးသည်။







Handwritten text in a cursive script, likely a historical document or manuscript. The text is written in a dark ink on aged paper and is arranged in approximately 25 horizontal lines. The script is highly stylized and difficult to decipher without specialized knowledge of the language or dialect. The document appears to be a formal record or a collection of entries, possibly related to a legal or administrative matter. The text is written in a cursive script, likely a historical document or manuscript. The text is written in a dark ink on aged paper and is arranged in approximately 25 horizontal lines. The script is highly stylized and difficult to decipher without specialized knowledge of the language or dialect. The document appears to be a formal record or a collection of entries, possibly related to a legal or administrative matter.







Handwritten text in a cursive script, likely a historical document or manuscript. The text is written in a dark ink on aged paper and is arranged in approximately 20 horizontal lines. The script is highly stylized and difficult to decipher without specialized knowledge of the language or dialect. The text appears to be a continuous passage, possibly a letter or a record, with some lines starting with what might be salutations or specific markers. The overall appearance is that of a well-preserved but challenging-to-read historical document.















Handwritten text in a cursive script, likely a historical document or manuscript. The text is written in a dark ink on aged, slightly yellowed paper. It consists of approximately 20 lines of text, with some lines starting with a double quote symbol. The script is dense and difficult to decipher without specialized knowledge of the language or dialect. The text appears to be a list or a series of entries, possibly related to a legal or administrative record. There are some faint markings and a large, light-colored smudge or stain in the lower right quadrant of the page.







Handwritten text in a cursive script, likely a historical document or manuscript. The text is written in a dark ink on aged paper and is arranged in approximately 25 horizontal lines. The script is dense and characteristic of early modern European handwriting. A large, semi-transparent watermark is visible in the center of the page, featuring a five-pointed star or starburst design. The watermark is light blue and partially obscures the underlying text. The text appears to be a formal document, possibly a contract or a record, given the structured nature of the lines and the presence of the watermark.















Handwritten text at the top of the page, possibly a title or header.

Main body of handwritten text, consisting of multiple lines of cursive script. The text is dense and fills most of the page.







Handwritten Burmese script, likely a religious or historical text, written in a cursive style. The text is arranged in approximately 20 horizontal lines across the page. The script is dense and characteristic of traditional Burmese calligraphy. There are several instances of double lines (//) used as section markers or line separators. A faint, large watermark is visible in the center of the page, featuring a star-like or floral design.







Handwritten text in a cursive script, likely a historical document or manuscript. The text is arranged in approximately 20 horizontal lines, with some lines containing multiple entries or phrases separated by double quotation marks. The script is dense and difficult to decipher without specialized knowledge of the language or dialect. The document appears to be a list or a series of entries, possibly related to a legal or administrative record. The text is written in dark ink on aged, slightly yellowed paper.







Handwritten text in a cursive script, likely a historical document or manuscript. The text is written in a dark ink on aged paper and is arranged in approximately 25 horizontal lines. The script is highly stylized and difficult to decipher without specialized knowledge of the language or dialect. The document appears to be a formal record or a set of instructions, given the structured nature of the lines and the use of some symbols that resemble punctuation or section markers. The paper shows signs of age, including some discoloration and a faint watermark or stamp in the center.















Handwritten text in a cursive script, likely a historical document or manuscript. The text is densely packed and spans the entire page, with some lines appearing to be crossed out or heavily faded. The script is highly stylized and difficult to decipher without specialized knowledge of the language or dialect used. The document is enclosed in a simple rectangular border.















Handwritten text in a cursive script, likely a historical document or manuscript. The text is written in a dark ink on aged paper and is arranged in approximately 25 horizontal lines. The script is highly stylized and difficult to decipher without specialized knowledge of the language or dialect. The document appears to be a formal record or a collection of entries, possibly related to land ownership or administrative matters, given the repetitive nature of some phrases and the use of what might be titles or identifiers. The text is densely packed and covers most of the page area.







Handwritten text in a cursive script, likely a historical document or manuscript. The text is densely packed and spans the entire page. It appears to be a list or a series of entries, possibly related to a collection or inventory. The script is highly stylized and difficult to decipher without specialized knowledge of the language or dialect used. The text is written in a dark ink on aged, slightly yellowed paper. There are some faint markings and a large, irregular blue-green stain on the right side of the page, which partially obscures some of the text. The overall appearance is that of an old, well-used manuscript.







































Handwritten text in a cursive script, likely a historical document or manuscript. The text is written in a dark ink on aged paper and is arranged in approximately 25 horizontal lines. The script is highly stylized and difficult to decipher. There are several instances of double lines, possibly indicating corrections or specific emphasis. A large, semi-transparent watermark is visible in the center of the page, partially obscuring the text. The watermark appears to be a circular emblem or logo, but its details are not clearly legible. The overall appearance is that of an old, handwritten document.







































Handwritten Burmese script, likely a religious or historical text, written in a cursive style. The text is arranged in approximately 25 horizontal lines across the page. The script is dense and characteristic of traditional Burmese calligraphy. A faint watermark is visible in the center of the page.







Handwritten text in a cursive script, likely a historical document or manuscript. The text is densely packed and spans the entire page. It appears to be a list or a series of entries, possibly related to a collection or inventory. The script is highly stylized and difficult to decipher without specialized knowledge of the language or dialect used. The text is written in dark ink on aged, slightly yellowed paper. There are some faint markings and a large, light-colored smudge or stain in the lower right quadrant of the page.















Handwritten Burmese script, likely a religious or historical text, written in a cursive style. The text is arranged in approximately 25 horizontal lines across the page. The script is dense and characteristic of traditional Burmese calligraphy. There are several instances of double lines (//) used as section markers or to separate phrases. A large, faint watermark of a five-pointed star is visible in the center of the page, partially overlapping the text. The paper shows signs of age, including some discoloration and wear.







Handwritten Burmese script, likely a historical document or manuscript. The text is densely packed and written in a cursive style. It appears to be a list or a series of entries, possibly related to military or administrative matters, given the use of terms like "တပ်" (army) and "သား" (son/child). The script is written on aged, slightly yellowed paper. The text is arranged in approximately 25 horizontal lines, with some lines starting with a double quote symbol (").































(Handwritten text in a cursive script, likely Burmese, covering the entire page. The text is arranged in approximately 25 horizontal lines, with some lines starting with a double quote symbol. The script is dense and difficult to decipher due to its cursive nature and the presence of a watermark.)

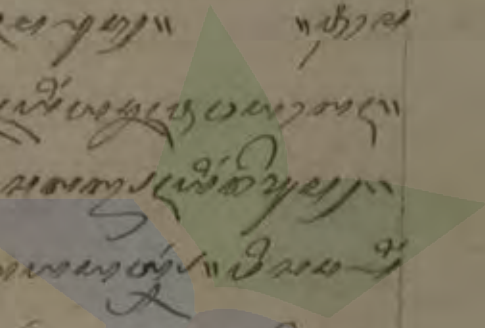







Handwritten text in a cursive script, likely a historical document or manuscript. The text is written in a dark ink on aged paper and is arranged in approximately 25 horizontal lines. The script is highly stylized and difficult to decipher. A large, semi-transparent watermark is visible in the center of the page, featuring a blue and green star-like shape. The watermark contains the text "Digitized by Google" and "www.google.com".







Handwritten text in a cursive script, likely a historical document or manuscript. The text is densely packed and spans the entire page. It appears to be a list or a series of entries, possibly related to a collection or inventory. The script is highly stylized and difficult to decipher without specialized knowledge of the language and script. The text is written in a dark ink on aged, slightly yellowed paper. There are some faint markings and a large, faint watermark or stamp in the center of the page, which is partially obscured by the text. The overall appearance is that of an old, handwritten document.















Handwritten Burmese script, likely a manuscript or historical document. The text is densely packed and written in a cursive style. It appears to be a collection of entries or a list, possibly related to a historical record or a collection of names. The script is written in black ink on aged paper. The text is arranged in approximately 25 horizontal lines, with some lines containing multiple entries separated by double slashes (//). The entries are written in a consistent, cursive hand, characteristic of traditional Burmese manuscript writing. The overall appearance is that of a well-preserved historical document.















Handwritten text in a cursive script, likely a historical document or manuscript. The text is densely packed and spans the entire page. It appears to be a list or a series of entries, possibly related to a collection or inventory. The script is highly stylized and difficult to decipher without specialized knowledge of the language and script. The text is written in dark ink on aged, slightly yellowed paper. There are some faint markings and a large, light-colored smudge or stain on the right side of the page, partially overlapping the text.







Handwritten text in a cursive script, likely a historical document or manuscript. The text is densely packed and spans most of the page.

Handwritten text in a cursive script, continuing from the previous section. It appears to be a separate paragraph or a continuation of the same document.































Main body of handwritten text in a cursive script, consisting of approximately 25 lines of dense, flowing characters.







Handwritten text in a cursive script, likely a historical document or manuscript. The text is densely packed and spans the entire page. The script is highly stylized and difficult to decipher without specialized knowledge of the language and script. The document appears to be a single page of text, possibly a letter or a page from a book. The ink is dark and the paper shows signs of age and wear.















Handwritten text in Khmer script, likely a manuscript or historical document. The text is densely packed and written in a cursive style. It appears to be a list or a series of entries, possibly related to a historical record or a collection of names. The script is highly stylized and difficult to read without specialized knowledge of the language and its historical forms. The text is arranged in approximately 20 horizontal lines across the page.







၁။ အဘယ့်ကြောင့် နေ့စဉ် နေထိုင်ရာ အလုပ်အကိုင်များကို စိတ်ချစွာ ပြုလုပ်နိုင်ရန် အရေးကြီးသည်။  
 ၂။ အလုပ်အကိုင်များကို စိတ်ချစွာ ပြုလုပ်နိုင်ရန် အရေးကြီးသည်။  
 ၃။ အလုပ်အကိုင်များကို စိတ်ချစွာ ပြုလုပ်နိုင်ရန် အရေးကြီးသည်။  
 ၄။ အလုပ်အကိုင်များကို စိတ်ချစွာ ပြုလုပ်နိုင်ရန် အရေးကြီးသည်။  
 ၅။ အလုပ်အကိုင်များကို စိတ်ချစွာ ပြုလုပ်နိုင်ရန် အရေးကြီးသည်။  
 ၆။ အလုပ်အကိုင်များကို စိတ်ချစွာ ပြုလုပ်နိုင်ရန် အရေးကြီးသည်။  
 ၇။ အလုပ်အကိုင်များကို စိတ်ချစွာ ပြုလုပ်နိုင်ရန် အရေးကြီးသည်။  
 ၈။ အလုပ်အကိုင်များကို စိတ်ချစွာ ပြုလုပ်နိုင်ရန် အရေးကြီးသည်။  
 ၉။ အလုပ်အကိုင်များကို စိတ်ချစွာ ပြုလုပ်နိုင်ရန် အရေးကြီးသည်။  
 ၁၀။ အလုပ်အကိုင်များကို စိတ်ချစွာ ပြုလုပ်နိုင်ရန် အရေးကြီးသည်။















Handwritten Burmese script, likely a historical document or manuscript. The text is densely packed and written in a cursive style. It appears to be a collection of entries or a list, possibly related to a royal decree or administrative record. The script is written in dark ink on aged, slightly yellowed paper. The text is arranged in approximately 20 horizontal lines, with some lines containing multiple columns of writing. The overall appearance is that of a well-preserved but aged historical document.















































































Handwritten Burmese script, likely a historical document or manuscript. The text is densely packed and written in a cursive style. It appears to be a list or a series of entries, possibly related to a royal decree or administrative record. The script is written in black ink on aged, slightly yellowed paper. The text is arranged in approximately 25 horizontal lines, with some lines starting with a double quote symbol ("). The content is difficult to decipher due to the cursive nature of the script and the lack of modern punctuation or spacing. The document is oriented vertically on the page.







































Handwritten text in Burmese script, consisting of approximately 10 lines of dense, cursive writing.

Handwritten text in Burmese script, consisting of approximately 10 lines of dense, cursive writing, continuing from the top section.















Handwritten text in a cursive script, likely a historical document or manuscript. The text is densely packed and spans the entire page. It appears to be a list or a series of entries, possibly related to a collection or inventory. The script is highly stylized and difficult to decipher without specialized knowledge of the language and script. The text is written in a dark ink on aged, slightly yellowed paper. There are some faint markings and a small blue mark on the right side of the page.















๑. ๒. ๓. ๔. ๕. ๖. ๗. ๘. ๙. ๑๐. ๑๑. ๑๒. ๑๓. ๑๔. ๑๕. ๑๖. ๑๗. ๑๘. ๑๙. ๒๐. ๒๑. ๒๒. ๒๓. ๒๔. ๒๕. ๒๖. ๒๗. ๒๘. ๒๙. ๓๐. ๓๑. ๓๒. ๓๓. ๓๔. ๓๕. ๓๖. ๓๗. ๓๘. ๓๙. ๔๐. ๔๑. ๔๒. ๔๓. ๔๔. ๔๕. ๔๖. ๔๗. ๔๘. ๔๙. ๕๐. ๕๑. ๕๒. ๕๓. ๕๔. ๕๕. ๕๖. ๕๗. ๕๘. ๕๙. ๖๐. ๖๑. ๖๒. ๖๓. ๖๔. ๖๕. ๖๖. ๖๗. ๖๘. ๖๙. ๗๐. ๗๑. ๗๒. ๗๓. ๗๔. ๗๕. ๗๖. ๗๗. ๗๘. ๗๙. ๘๐. ๘๑. ๘๒. ๘๓. ๘๔. ๘๕. ๘๖. ๘๗. ๘๘. ๘๙. ๙๐. ๙๑. ๙๒. ๙๓. ๙๔. ๙๕. ๙๖. ๙๗. ๙๘. ๙๙. ๑๐๐.







Handwritten text in a cursive script, likely a historical document or manuscript. The text is densely packed and spans the entire page. It appears to be a list or a series of entries, possibly related to a collection or inventory. The script is highly stylized and difficult to decipher without specialized knowledge of the language or dialect used. The text is written in dark ink on aged, slightly yellowed paper. There are some faint markings and a large, irregular blue stain in the center-right area of the page, which partially obscures some of the text. The overall appearance is that of an old, well-used manuscript.







Handwritten text in a cursive script, likely a historical document or manuscript. The text is densely packed and spans the entire page. It appears to be a list or a series of entries, possibly related to a collection or inventory. The script is highly stylized and difficult to decipher without specialized knowledge of the language and script. There are some faint markings and what might be a small illustration or stamp in the center-right area.







Handwritten text in Khmer script, consisting of approximately 15 lines of dense, cursive writing. The text is written in black ink on aged paper. The characters are closely spaced and flow from left to right across each line. There are some faint markings and a small blue mark on the page.

Handwritten text in Khmer script, consisting of approximately 5 lines of dense, cursive writing. This section is located at the bottom of the page and continues the style of the text above. The ink is dark, and the paper shows signs of age and wear.



Main body of handwritten text, consisting of approximately 25 lines of dense script.











Handwritten Burmese script, likely a historical document or manuscript. The text is densely packed and written in a cursive style. It appears to be a list or a series of entries, possibly related to a royal decree or administrative record. The script is written in black ink on aged paper. The text is arranged in approximately 25 horizontal lines, with some lines starting with a small symbol or character that might indicate a section or item number. The overall appearance is that of a well-preserved but aged historical document.







Handwritten Khmer text in a cursive script, likely a manuscript or a collection of sayings. The text is densely packed and covers most of the page. It appears to be a list of phrases or a continuous narrative, with many lines starting with a double quote symbol ("). The script is highly stylized and characteristic of traditional Khmer calligraphy. The text is written in black ink on aged, slightly yellowed paper. There are some faint markings and a small blueish stain in the middle of the page, but the overall legibility of the script is maintained.



Handwritten Burmese script, likely a religious or historical text, written in a cursive style. The text is arranged in approximately 25 horizontal lines across the page. The script is dense and characteristic of traditional Burmese calligraphy. There are some faint markings and a small blue rectangular stamp or mark in the middle of the page.



Handwritten text in Khmer script, likely a manuscript or historical document. The text is densely packed and written in a cursive style. It appears to be a collection of phrases or a short narrative, possibly related to a religious or historical context. The script is highly stylized and difficult to decipher without specialized knowledge of the language and its historical forms. The text is written on aged, slightly yellowed paper.







Handwritten Burmese script, likely a manuscript or official document. The text is densely packed and written in a cursive style. It appears to be a list or a series of entries, possibly related to a historical record or a collection of items. The script is written in black ink on aged, slightly yellowed paper. There are some faint markings and a small blue rectangular stamp or mark in the middle of the page, which might be a library or archival stamp. The overall appearance is that of an old, well-preserved document.















Handwritten Burmese script, likely a manuscript or official document. The text is densely packed and written in a cursive style. It appears to be a list or a series of entries, possibly related to a historical record or a collection of items. The script is written in black ink on aged, slightly yellowed paper. The text is arranged in approximately 20 horizontal lines, with some lines starting with a double quote symbol ("). The characters are small and closely spaced, characteristic of traditional Burmese handwriting. The overall appearance is that of an old, well-preserved document.







Handwritten text in a cursive script, likely a historical document or manuscript. The text is densely packed and spans most of the page. It appears to be a list or a series of entries, possibly related to a collection or inventory. The script is highly stylized and difficult to decipher without specialized knowledge of the language and script. The text is written in dark ink on aged, slightly yellowed paper. There are some faint markings and a small blue mark on the right side of the page.







Handwritten text in a cursive script, likely a historical document or manuscript. The text is written in a dark ink on aged paper. It begins with a large initial letter, possibly 'A', and continues with several lines of text. The script is dense and characteristic of 17th or 18th-century handwriting.

Handwritten text in a cursive script, continuing from the previous block. The text is written in a dark ink on aged paper. It begins with a large initial letter, possibly 'B', and continues with several lines of text. The script is dense and characteristic of 17th or 18th-century handwriting.

Handwritten text in a cursive script, continuing from the previous block. The text is written in a dark ink on aged paper. It begins with a large initial letter, possibly 'C', and continues with several lines of text. The script is dense and characteristic of 17th or 18th-century handwriting.

Handwritten text in a cursive script, continuing from the previous block. The text is written in a dark ink on aged paper. It begins with a large initial letter, possibly 'D', and continues with several lines of text. The script is dense and characteristic of 17th or 18th-century handwriting.







Handwritten text at the top left of the page.

Main body of handwritten text, consisting of approximately 20 lines of dense script.







Handwritten text in a cursive script, likely a historical document or manuscript. The text is written in a dark ink on aged paper. It consists of approximately 20 lines of text, with some lines starting with a double quote symbol ("). The script is dense and difficult to decipher due to its cursive nature and the age of the document. The text appears to be a list or a series of entries, possibly related to a historical record or a collection of documents. The lines are roughly horizontal, following the curve of the page. There are some faint markings and a small blue mark on the right side of the page, which might be a stamp or a mark from a previous owner. The overall appearance is that of an old, well-preserved manuscript.







Handwritten text in a cursive script, likely a historical document or manuscript. The text is densely packed and spans most of the page.

Handwritten text in a cursive script, continuing from the previous section. It is located at the bottom of the page.























Handwritten Burmese script, likely a historical document or manuscript. The text is densely packed and written in a cursive style. It appears to be a list or a series of entries, possibly related to military or administrative matters, given the use of terms like "တပ်" (army) and "သား" (son/child). The script is written in black ink on aged, slightly yellowed paper. There are some faint markings and a large, light-colored smudge or stain in the center-right area of the page.







Handwritten Burmese script, likely a historical document or manuscript. The text is densely packed and written in a cursive style. It appears to be a collection of entries or a list, possibly related to military or administrative matters, given the use of terms like 'တပ်' (army) and 'သား' (son/child). The script is written on aged, slightly yellowed paper. There are some faint markings and a large, light-colored smudge or stain in the center-right area of the page.







Handwritten Burmese text, likely a religious or historical document, written in a cursive script. The text is arranged in approximately 15 horizontal lines, with some characters appearing to be in a different script or dialect. The ink is dark, and the paper shows signs of age and wear.

Handwritten Burmese text, continuing from the top section. This section contains approximately 15 lines of text, maintaining the same cursive script. The handwriting is consistent with the upper portion of the page.







အဘယ့်ကြောင့်ဟူ၍ မေးရာ၌ ဤသို့ ဖြေဆိုတော်မူ၏။

“ ဤသို့ ဖြေဆိုတော်မူ၍ ဤသို့ ဖြေဆိုတော်မူ၍

အဘယ့်ကြောင့်ဟူ၍ မေးရာ၌ ဤသို့ ဖြေဆိုတော်မူ၏။

“ ဤသို့ ဖြေဆိုတော်မူ၍ ဤသို့ ဖြေဆိုတော်မူ၍

အဘယ့်ကြောင့်ဟူ၍ မေးရာ၌ ဤသို့ ဖြေဆိုတော်မူ၏။

“ ဤသို့ ဖြေဆိုတော်မူ၍ ဤသို့ ဖြေဆိုတော်မူ၍

အဘယ့်ကြောင့်ဟူ၍ မေးရာ၌ ဤသို့ ဖြေဆိုတော်မူ၏။

“ ဤသို့ ဖြေဆိုတော်မူ၍ ဤသို့ ဖြေဆိုတော်မူ၍

အဘယ့်ကြောင့်ဟူ၍ မေးရာ၌ ဤသို့ ဖြေဆိုတော်မူ၏။

“ ဤသို့ ဖြေဆိုတော်မူ၍ ဤသို့ ဖြေဆိုတော်မူ၍

အဘယ့်ကြောင့်ဟူ၍ မေးရာ၌ ဤသို့ ဖြေဆိုတော်မူ၏။

“ ဤသို့ ဖြေဆိုတော်မူ၍ ဤသို့ ဖြေဆိုတော်မူ၍



Main body of handwritten text, consisting of approximately 25 lines of dense script.



Handwritten text in a cursive script, likely a historical document or manuscript.

Handwritten text in a cursive script, likely a historical document or manuscript.

Handwritten text in a cursive script, likely a historical document or manuscript.

Handwritten text in a cursive script, likely a historical document or manuscript.

Handwritten text in a cursive script, likely a historical document or manuscript.

Handwritten text in a cursive script, likely a historical document or manuscript.

Handwritten text in a cursive script, likely a historical document or manuscript.

Handwritten text in a cursive script, likely a historical document or manuscript.

Handwritten text in a cursive script, likely a historical document or manuscript.

Handwritten text in a cursive script, likely a historical document or manuscript.







Handwritten Burmese script, likely a religious or historical text, written in a cursive style. The text is densely packed and covers most of the page. It appears to be a collection of verses or a continuous narrative. The script is dark and well-defined against the light background of the paper. There are some faint markings and a small blue stamp or mark in the middle-right section of the page.























Handwritten text in Khmer script, likely a historical document or manuscript. The text is densely packed and written in a cursive style. It appears to be a list or a series of entries, possibly related to a royal decree or administrative record. The script is highly stylized and difficult to read without specialized knowledge of the language and its historical forms. The document is written on aged, yellowed paper.







































Handwritten Burmese script, likely a historical document or manuscript. The text is densely packed and written in a cursive style. It appears to be a list or a series of entries, possibly related to a royal decree or administrative record. The script is written in black ink on aged, slightly yellowed paper. The text is arranged in approximately 20 horizontal lines, with some lines starting with a small symbol or character. The overall appearance is that of an old, well-preserved manuscript.







Handwritten Burmese script, likely a historical document or manuscript. The text is densely packed and written in a cursive style. It appears to be a list or a series of entries, possibly related to a royal decree or administrative record. The script is written in black ink on aged, slightly yellowed paper. The text is arranged in approximately 20 horizontal lines, with some lines starting with a small decorative symbol or character. The overall appearance is that of a well-preserved but clearly aged historical document.















































Handwritten text in a cursive script, likely a historical document or manuscript. The text is densely packed and spans the entire page. The script is highly stylized and difficult to decipher without specialized knowledge of the language and script. The document appears to be a formal record or a collection of entries, possibly related to a legal or administrative context. The text is written in a dark ink on aged, slightly yellowed paper. There are some faint markings and a small blue mark on the right side of the page.







Handwritten text in a cursive script, likely a historical document or manuscript. The text is dense and fills the upper portion of the page.

Handwritten text in a cursive script, continuing from the top section. The text is dense and fills the lower portion of the page. There are some faint markings and possibly a watermark or stamp visible in the background.































Handwritten text in a cursive script, likely a historical document or manuscript. The text is written in a dark ink on aged paper and is arranged in approximately 20 horizontal lines. The script is highly stylized and difficult to decipher without specialized knowledge of the language or dialect. The document appears to be a formal record or a collection of entries, possibly related to a legal or administrative matter. The text is written in a cursive script, likely a historical document or manuscript. The text is written in a dark ink on aged paper and is arranged in approximately 20 horizontal lines. The script is highly stylized and difficult to decipher without specialized knowledge of the language or dialect. The document appears to be a formal record or a collection of entries, possibly related to a legal or administrative matter.



























Handwritten Burmese script, top section of the page.

Main body of handwritten Burmese script, including a large blue watermark.



Handwritten text in a cursive script, likely a historical document or manuscript. The text is densely packed and spans the entire page. The script is highly stylized and difficult to decipher without specialized knowledge of the language and dialect. The document appears to be a collection of entries or a list, with many lines starting with a small symbol or character. The text is written in dark ink on aged, slightly yellowed paper. There are some faint markings and a large, light-colored smudge or stain in the lower right quadrant of the page.







Handwritten text in a cursive script, likely a historical document or manuscript. The text is densely packed and spans the entire page. The script is highly stylized and difficult to decipher. The document appears to be a list or a series of entries, possibly related to a collection or inventory. The text is written in a dark ink on aged, slightly yellowed paper. There are some faint markings and a large, light-colored smudge or stain in the center-right area of the page.







Handwritten text in a cursive script, likely a historical document or manuscript. The text is densely packed and spans the upper two-thirds of the page. It appears to be a list or a series of entries, possibly related to a collection or inventory. The script is highly stylized and difficult to decipher without specialized knowledge of the language.

Handwritten text in a cursive script, continuing from the upper section. This section contains several lines of text, some of which are partially obscured by a large, light-colored watermark or stain in the center of the page. The text is dense and appears to be a continuation of the list or entries from the upper section.















Handwritten text in Khmer script, likely a manuscript or historical document. The text is densely packed and written in a cursive style. It appears to be a list or a series of entries, possibly related to a historical record or a collection of items. The script is highly stylized and difficult to read without specialized knowledge of the language and its historical forms. The text is arranged in approximately 20 horizontal lines across the page.







Handwritten text in Khmer script, likely a manuscript or historical document. The text is densely packed and written in a cursive style. It appears to be a list or a series of entries, possibly related to a historical record or a collection of names. The script is highly stylized and difficult to decipher without specialized knowledge of Khmer paleography. The text is arranged in approximately 20 horizontal lines across the page.







Handwritten text in Khmer script, likely a manuscript or historical document. The text is densely packed and written in a cursive style. It appears to be a list or a series of entries, possibly related to a historical record or a collection of names. The script is highly stylized and difficult to decipher without specialized knowledge of Khmer paleography. The text is arranged in approximately 25 horizontal lines across the page.







Handwritten Burmese script, likely a manuscript or official document, written in a cursive style. The text is arranged in approximately 25 horizontal lines across the page. The script is dense and characteristic of traditional Burmese calligraphy. A large, semi-transparent watermark is visible in the center of the page, featuring a circular emblem with a crown and other royal symbols, surrounded by text in a different script, likely Thai or another Southeast Asian language. The watermark is oriented vertically and partially obscures the underlying Burmese text.







Handwritten text in a cursive script, likely a historical document or manuscript. The text is densely packed and spans the entire page. It appears to be a list or a series of entries, possibly related to a collection or inventory. The script is highly stylized and difficult to decipher without specialized knowledge of the language and script. The text is written in black ink on aged, slightly yellowed paper. There are some faint markings and a small blue rectangular mark on the right side of the page.







Handwritten text in Khmer script, top section.

Main body of handwritten text in Khmer script, consisting of multiple lines.















Handwritten text at the top of the page, possibly a title or header.

Main body of handwritten text, consisting of multiple lines of cursive script.



















Handwritten Burmese text at the top of the page, consisting of several lines of script.

Main body of handwritten Burmese text, densely packed and covering most of the page. The script is cursive and includes various characters and symbols.



Handwritten text in a cursive script, likely a historical document or manuscript. The text is densely packed and covers most of the page. It appears to be written in a language that may be related to the region, possibly using a script like the Khmer or Thai script, though the characters are highly stylized and difficult to decipher. The text is organized into several lines, with some lines starting with a small symbol or character. The overall appearance is that of an old, handwritten document.







Handwritten text in Khmer script, consisting of approximately 10 lines of dense, cursive writing.

Handwritten text in Khmer script, consisting of approximately 10 lines of dense, cursive writing.







































Handwritten Burmese script, likely a historical document or manuscript. The text is densely packed and written in a cursive style. It appears to be a list or a series of entries, possibly related to a royal decree or administrative record. The script is written in black ink on aged, slightly yellowed paper. The text is arranged in approximately 25 horizontal lines, with some lines starting with a small decorative flourish or symbol. The overall appearance is that of a well-preserved but clearly aged piece of historical writing.







Handwritten text in a cursive script, likely a historical document or manuscript. The text is written in a dark ink on aged paper and is arranged in approximately 20 horizontal lines. The script is highly stylized and difficult to decipher. The document appears to be a formal record or a set of instructions, given the structured nature of the lines and the use of some larger, possibly decorative, characters. The text is written from left to right, following the traditional orientation of the page.











๑๐๑  
 ๑๐๒  
 ๑๐๓  
 ๑๐๔  
 ๑๐๕  
 ๑๐๖  
 ๑๐๗  
 ๑๐๘  
 ๑๐๙  
 ๑๑๐  
 ๑๑๑  
 ๑๑๒  
 ๑๑๓  
 ๑๑๔  
 ๑๑๕  
 ๑๑๖  
 ๑๑๗  
 ๑๑๘  
 ๑๑๙  
 ๑๒๐  
 ๑๒๑  
 ๑๒๒  
 ๑๒๓  
 ๑๒๔  
 ๑๒๕  
 ๑๒๖  
 ๑๒๗  
 ๑๒๘  
 ๑๒๙  
 ๑๓๐  
 ๑๓๑  
 ๑๓๒  
 ๑๓๓  
 ๑๓๔  
 ๑๓๕  
 ๑๓๖  
 ๑๓๗  
 ๑๓๘  
 ๑๓๙  
 ๑๔๐  
 ๑๔๑  
 ๑๔๒  
 ๑๔๓  
 ๑๔๔  
 ๑๔๕  
 ๑๔๖  
 ๑๔๗  
 ๑๔๘  
 ๑๔๙  
 ๑๕๐  
 ๑๕๑  
 ๑๕๒  
 ๑๕๓  
 ๑๕๔  
 ๑๕๕  
 ๑๕๖  
 ๑๕๗  
 ๑๕๘  
 ๑๕๙  
 ๑๖๐  
 ๑๖๑  
 ๑๖๒  
 ๑๖๓  
 ๑๖๔  
 ๑๖๕  
 ๑๖๖  
 ๑๖๗  
 ๑๖๘  
 ๑๖๙  
 ๑๗๐  
 ๑๗๑  
 ๑๗๒  
 ๑๗๓  
 ๑๗๔  
 ๑๗๕  
 ๑๗๖  
 ๑๗๗  
 ๑๗๘  
 ๑๗๙  
 ๑๘๐  
 ๑๘๑  
 ๑๘๒  
 ๑๘๓  
 ๑๘๔  
 ๑๘๕  
 ๑๘๖  
 ๑๘๗  
 ๑๘๘  
 ๑๘๙  
 ๑๙๐  
 ๑๙๑  
 ๑๙๒  
 ๑๙๓  
 ๑๙๔  
 ๑๙๕  
 ๑๙๖  
 ๑๙๗  
 ๑๙๘  
 ๑๙๙  
 ๒๐๐



Handwritten Burmese script, likely a historical document or manuscript, written in a cursive style. The text is densely packed and covers most of the page. It appears to be a continuous narrative or record, possibly related to military or administrative matters, given the use of terms like 'king' and 'army'.







Handwritten text in a cursive script, likely a historical document or manuscript. The text is densely packed and spans the entire page. It appears to be a list or a series of entries, possibly related to a collection or inventory. The script is highly stylized and difficult to decipher without specialized knowledge of the language and script. The text is written in dark ink on aged, slightly yellowed paper. There are some faint markings and a small blue stamp or mark on the right side of the page.















Handwritten text in a cursive script, likely a historical document or manuscript. The text is written in a dark ink on aged, yellowish paper. The script is dense and fills most of the page, with some lines appearing to be part of a list or a series of entries. The handwriting is characteristic of the 17th or 18th century. There are some faint markings and a large, light-colored smudge or stain in the lower right quadrant of the page.







Handwritten text in Burmese script, consisting of several lines of dense, cursive writing.

Handwritten text in Burmese script, consisting of several lines of dense, cursive writing. A large, faint watermark is visible in the center of the page, partially overlapping the text.







Handwritten text in a cursive script, likely a historical document or manuscript. The text is densely packed and covers most of the page. It appears to be a list or a series of entries, possibly related to a collection or inventory. The script is highly stylized and difficult to decipher without specialized knowledge of the language and script. The text is written in dark ink on aged, slightly yellowed paper. There are some faint markings and a small blue stamp or mark in the center of the page, which might be a library or archival stamp. The overall appearance is that of an old, well-used manuscript.















Handwritten text in Khmer script, likely a historical document or manuscript. The text is densely packed and written in a cursive style. It appears to be a list or a series of entries, possibly related to land or administrative matters, given the use of terms like "land" (ដី) and "household" (គ្រួសារ). The script is highly stylized and difficult to read without specialized knowledge of the language and its historical forms.















Handwritten text in a cursive script, likely a historical document or manuscript. The text is written in a dark ink on aged paper and is oriented vertically. The script is highly stylized and difficult to decipher. The document appears to be a list or a series of entries, with some lines starting with a double quote symbol. The text is densely packed and covers most of the page.







Handwritten Burmese script, likely a historical document or manuscript. The text is densely packed and written in a cursive style. It appears to be a list or a series of entries, possibly related to a royal decree or administrative record. The script is written in black ink on aged paper. The text is arranged in approximately 20 horizontal lines, with some lines starting with a small symbol or character. The overall appearance is that of a well-preserved but aged historical document.















Handwritten text at the top of the page, likely a header or title, written in a cursive script.

Main body of handwritten text, consisting of multiple lines of cursive script. The text is densely packed and appears to be a continuous narrative or list of entries.







Handwritten text in a cursive script, likely a historical document or manuscript. The text is densely packed and spans the entire page. The script is highly stylized and difficult to decipher. The document appears to be a formal record or a legal document, given the structured nature of the entries and the use of various symbols and flourishes. The text is written in a dark ink on aged, slightly yellowed paper. There are some faint markings and a large, light-colored smudge or stain in the lower right quadrant of the page.







Handwritten text in a cursive script, likely a historical document or manuscript. The text is densely packed and spans the entire page. It appears to be written in a language that may be related to the Burmese or Thai scripts, given the context of the image. The ink is dark, and the paper shows signs of age and wear. There are some faint markings and a small blue mark on the right side of the page.



Handwritten text in a cursive script, likely a historical document or manuscript.

Main body of handwritten text in a cursive script, consisting of multiple lines of dense writing.



Handwritten text in a cursive script, likely a historical document or manuscript. The text is densely packed and spans the entire page. It appears to be a list or a series of entries, possibly related to a collection or inventory. The script is highly stylized and difficult to decipher without specialized knowledge of the language and script. The text is written in dark ink on aged, slightly yellowed paper. There are some faint markings and a large, light-colored smudge or stain in the lower right quadrant of the page.



1. 2. 3. 4. 5. 6. 7. 8. 9. 10. 11. 12. 13. 14. 15. 16. 17. 18. 19. 20. 21. 22. 23. 24. 25. 26. 27. 28. 29. 30. 31. 32. 33. 34. 35. 36. 37. 38. 39. 40. 41. 42. 43. 44. 45. 46. 47. 48. 49. 50. 51. 52. 53. 54. 55. 56. 57. 58. 59. 60. 61. 62. 63. 64. 65. 66. 67. 68. 69. 70. 71. 72. 73. 74. 75. 76. 77. 78. 79. 80. 81. 82. 83. 84. 85. 86. 87. 88. 89. 90. 91. 92. 93. 94. 95. 96. 97. 98. 99. 100. 101. 102. 103. 104. 105. 106. 107. 108. 109. 110. 111. 112. 113. 114. 115. 116. 117. 118. 119. 120. 121. 122. 123. 124. 125. 126. 127. 128. 129. 130. 131. 132. 133. 134. 135. 136. 137. 138. 139. 140. 141. 142. 143. 144. 145. 146. 147. 148. 149. 150. 151. 152. 153. 154. 155. 156. 157. 158. 159. 160. 161. 162. 163. 164. 165. 166. 167. 168. 169. 170. 171. 172. 173. 174. 175. 176. 177. 178. 179. 180. 181. 182. 183. 184. 185. 186. 187. 188. 189. 190. 191. 192. 193. 194. 195. 196. 197. 198. 199. 200. 201. 202. 203. 204. 205. 206. 207. 208. 209. 210. 211. 212. 213. 214. 215. 216. 217. 218. 219. 220. 221. 222. 223. 224. 225. 226. 227. 228. 229. 230. 231. 232. 233. 234. 235. 236. 237. 238. 239. 240. 241. 242. 243. 244. 245. 246. 247. 248. 249. 250. 251. 252. 253. 254. 255. 256. 257. 258. 259. 260. 261. 262. 263. 264. 265. 266. 267. 268. 269. 270. 271. 272. 273. 274. 275. 276. 277. 278. 279. 280. 281. 282. 283. 284. 285. 286. 287. 288. 289. 290. 291. 292. 293. 294. 295. 296. 297. 298. 299. 300. 301. 302. 303. 304. 305. 306. 307. 308. 309. 310. 311. 312. 313. 314. 315. 316. 317. 318. 319. 320. 321. 322. 323. 324. 325. 326. 327. 328. 329. 330. 331. 332. 333. 334. 335. 336. 337. 338. 339. 340. 341. 342. 343. 344. 345. 346. 347. 348. 349. 350. 351. 352. 353. 354. 355. 356. 357. 358. 359. 360. 361. 362. 363. 364. 365. 366. 367. 368. 369. 370. 371. 372. 373. 374. 375. 376. 377. 378. 379. 380. 381. 382. 383. 384. 385. 386. 387. 388. 389. 390. 391. 392. 393. 394. 395. 396. 397. 398. 399. 400. 401. 402. 403. 404. 405. 406. 407. 408. 409. 410. 411. 412. 413. 414. 415. 416. 417. 418. 419. 420. 421. 422. 423. 424. 425. 426. 427. 428. 429. 430. 431. 432. 433. 434. 435. 436. 437. 438. 439. 440. 441. 442. 443. 444. 445. 446. 447. 448. 449. 450. 451. 452. 453. 454. 455. 456. 457. 458. 459. 460. 461. 462. 463. 464. 465. 466. 467. 468. 469. 470. 471. 472. 473. 474. 475. 476. 477. 478. 479. 480. 481. 482. 483. 484. 485. 486. 487. 488. 489. 490. 491. 492. 493. 494. 495. 496. 497. 498. 499. 500. 501. 502. 503. 504. 505. 506. 507. 508. 509. 510. 511. 512. 513. 514. 515. 516. 517. 518. 519. 520. 521. 522. 523. 524. 525. 526. 527. 528. 529. 530. 531. 532. 533. 534. 535. 536. 537. 538. 539. 540. 541. 542. 543. 544. 545. 546. 547. 548. 549. 550. 551. 552. 553. 554. 555. 556. 557. 558. 559. 560. 561. 562. 563. 564. 565. 566. 567. 568. 569. 570. 571. 572. 573. 574. 575. 576. 577. 578. 579. 580. 581. 582. 583. 584. 585. 586. 587. 588. 589. 590. 591. 592. 593. 594. 595. 596. 597. 598. 599. 600. 601. 602. 603. 604. 605. 606. 607. 608. 609. 610. 611. 612. 613. 614. 615. 616. 617. 618. 619. 620. 621. 622. 623. 624. 625. 626. 627. 628. 629. 630. 631. 632. 633. 634. 635. 636. 637. 638. 639. 640. 641. 642. 643. 644. 645. 646. 647. 648. 649. 650. 651. 652. 653. 654. 655. 656. 657. 658. 659. 660. 661. 662. 663. 664. 665. 666. 667. 668. 669. 670. 671. 672. 673. 674. 675. 676. 677. 678. 679. 680. 681. 682. 683. 684. 685. 686. 687. 688. 689. 690. 691. 692. 693. 694. 695. 696. 697. 698. 699. 700. 701. 702. 703. 704. 705. 706. 707. 708. 709. 710. 711. 712. 713. 714. 715. 716. 717. 718. 719. 720. 721. 722. 723. 724. 725. 726. 727. 728. 729. 730. 731. 732. 733. 734. 735. 736. 737. 738. 739. 740. 741. 742. 743. 744. 745. 746. 747. 748. 749. 750. 751. 752. 753. 754. 755. 756. 757. 758. 759. 760. 761. 762. 763. 764. 765. 766. 767. 768. 769. 770. 771. 772. 773. 774. 775. 776. 777. 778. 779. 780. 781. 782. 783. 784. 785. 786. 787. 788. 789. 790. 791. 792. 793. 794. 795. 796. 797. 798. 799. 800. 801. 802. 803. 804. 805. 806. 807. 808. 809. 810. 811. 812. 813. 814. 815. 816. 817. 818. 819. 820. 821. 822. 823. 824. 825. 826. 827. 828. 829. 830. 831. 832. 833. 834. 835. 836. 837. 838. 839. 840. 841. 842. 843. 844. 845. 846. 847. 848. 849. 850. 851. 852. 853. 854. 855. 856. 857. 858. 859. 860. 861. 862. 863. 864. 865. 866. 867. 868. 869. 870. 871. 872. 873. 874. 875. 876. 877. 878. 879. 880. 881. 882. 883. 884. 885. 886. 887. 888. 889. 890. 891. 892. 893. 894. 895. 896. 897. 898. 899. 900. 901. 902. 903. 904. 905. 906. 907. 908. 909. 910. 911. 912. 913. 914. 915. 916. 917. 918. 919. 920. 921. 922. 923. 924. 925. 926. 927. 928. 929. 930. 931. 932. 933. 934. 935. 936. 937. 938. 939. 940. 941. 942. 943. 944. 945. 946. 947. 948. 949. 950. 951. 952. 953. 954. 955. 956. 957. 958. 959. 960. 961. 962. 963. 964. 965. 966. 967. 968. 969. 970. 971. 972. 973. 974. 975. 976. 977. 978. 979. 980. 981. 982. 983. 984. 985. 986. 987. 988. 989. 990. 991. 992. 993. 994. 995. 996. 997. 998. 999. 1000.



Handwritten Burmese script, likely a historical document or manuscript. The text is densely packed and written in a cursive style. It appears to be a list or a series of entries, possibly related to a royal decree or a historical record. The script is written in black ink on aged paper. The text is arranged in approximately 20 horizontal lines, with some lines containing multiple entries separated by small symbols or punctuation. The overall appearance is that of a well-preserved but aged historical document.







Handwritten text in a cursive script, likely a historical document or manuscript. The text is written in a dark ink on aged paper and is arranged in approximately 20 horizontal lines. The script is highly stylized and difficult to decipher. The document appears to be a formal record or a set of instructions, possibly related to a military or administrative context, given the use of terms like "regiment" and "company" in some of the legible fragments. The text is written in a language that appears to be a form of Latin or a related European language from the early modern period. The overall appearance is that of a well-preserved but challenging-to-read historical document.







Handwritten text in a cursive script, likely a historical document or manuscript. The text is densely packed and spans the entire page. It appears to be a list or a series of entries, possibly related to a collection or inventory. The script is highly stylized and difficult to decipher without specialized knowledge of the language and script. The text is written in a dark ink on aged, slightly yellowed paper. There are some faint markings and a large, light-colored smudge or stain in the lower right quadrant of the page.







Handwritten Burmese script, likely a manuscript or historical document. The text is densely packed and written in a cursive style. It appears to be a list or a series of entries, possibly related to a historical record or a collection of names. The script is written in black ink on aged paper. The text is arranged in approximately 25 horizontal lines, with some lines containing multiple entries separated by small symbols or markers. The overall appearance is that of a well-preserved but somewhat faded historical document.







Handwritten text in a cursive script, likely a historical document or manuscript. The text is densely packed and spans the entire page. The script is highly stylized and difficult to decipher. The document appears to be a collection of entries or a list, with many lines starting with a double quote symbol ("). The text is written in dark ink on aged, slightly yellowed paper. There are some faint markings and a large, light-colored smudge or stain in the lower right quadrant of the page.















Handwritten text in Khmer script, likely a historical document or manuscript. The text is densely packed and covers the entire page. It appears to be a record of events or a formal document, possibly related to the Khmer Rouge regime given the context of the image. The script is in a traditional style, and the document is heavily annotated with red markings, including lines, circles, and arrows, suggesting a process of review or editing. The text is written in a cursive, flowing style characteristic of Khmer calligraphy. The document is oriented vertically on the page.















Handwritten text in a cursive script, likely a historical document or manuscript. The text is densely packed and spans the entire page. It appears to be a list or a series of entries, possibly related to a collection or inventory. The script is highly stylized and difficult to decipher without specialized knowledge of the language and script. The text is written in a dark ink on aged paper. There are some faint markings and a large, light-colored stain on the right side of the page.















Handwritten text in a cursive script, likely a historical document or manuscript. The text is densely packed and spans the entire page. It appears to be a list or a series of entries, possibly related to a collection or inventory. The script is highly stylized and difficult to decipher without specialized knowledge of the language and script. The text is written in dark ink on aged, slightly yellowed paper. There are some faint markings and a large, light-colored smudge or stain in the lower right quadrant of the page.







Handwritten text in a cursive script, likely a historical document or manuscript. The text is densely packed and spans the entire page, with some lines appearing to be part of a list or a series of entries. The script is highly stylized and difficult to decipher without specialized knowledge of the language and script. The text is written in dark ink on aged, slightly yellowed paper. There are some faint markings and a large green watermark or stain in the center of the page.















Handwritten text in a cursive script, likely a historical document or manuscript. The text is densely packed and spans the entire page. It appears to be a list or a series of entries, possibly related to a collection or inventory. The script is highly stylized and difficult to decipher without specialized knowledge of the language and script. The text is written in a dark ink on aged, slightly yellowed paper. There are some faint markings and a small blue rectangular mark on the right side of the page, which could be a stamp or a piece of tape. The overall appearance is that of an old, handwritten document.















Handwritten text in Khmer script, consisting of multiple lines of dense, cursive writing. The text is arranged in approximately 15 horizontal lines across the page. The script is highly stylized and difficult to decipher without specialized knowledge of the language and its historical forms. The ink is dark, and the paper shows signs of age and wear.







Handwritten text in a cursive script, likely a historical document or manuscript. The text is densely packed and spans the entire page. It appears to be a list or a series of entries, possibly related to a collection or inventory. The script is highly stylized and difficult to decipher without specialized knowledge of the language or dialect used. The text is written in dark ink on aged, slightly yellowed paper. There are some faint markings and a large, light-colored smudge or stain in the center-right area of the page.







Handwritten text in a cursive script, likely a historical document or manuscript. The text is densely packed and spans the entire page. It appears to be a list or a series of entries, possibly related to a collection or inventory. The script is highly stylized and difficult to decipher without specialized knowledge of the language and script. The text is written in dark ink on aged, slightly yellowed paper. There are some faint markings and a large, light-colored smudge or stain in the center of the page, which partially obscures some of the text. The overall appearance is that of an old, well-used document.







Handwritten Burmese script, likely a historical document or manuscript. The text is densely packed and written in a cursive style. It appears to be a list or a series of entries, possibly related to military or administrative matters, given the use of terms like "တပ်" (army) and "သား" (son/child). The script is written in black ink on aged, slightly yellowed paper. There are some faint markings and a large, light-colored smudge or stain in the lower right quadrant of the page.















Handwritten text in a cursive script, likely a historical document or manuscript. The text is densely packed and spans the entire page. It appears to be a list or a series of entries, possibly related to a collection or inventory. The script is highly stylized and difficult to decipher without specialized knowledge of the language and script. The text is written in a dark ink on aged, slightly yellowed paper. There are some faint markings and a large, light-colored smudge or stain in the lower right quadrant of the page.







Handwritten text in a cursive script, likely Burmese, covering the entire page. The text is densely packed and includes several lines of script. There are some faint markings and a small blue mark on the right side of the page.







Handwritten text in a cursive script, likely a historical document or manuscript. The text is densely packed and spans the entire page. It appears to be a list or a series of entries, possibly related to a legal or administrative record. The script is highly stylized and difficult to decipher without specialized knowledge of the language and script. The text is written in dark ink on aged, slightly yellowed paper. There are some faint markings and a small blue stamp or mark in the lower right quadrant of the page.



၁၅၅၀  
 ၁၅၅၁  
 ၁၅၅၂  
 ၁၅၅၃  
 ၁၅၅၄  
 ၁၅၅၅  
 ၁၅၅၆  
 ၁၅၅၇  
 ၁၅၅၈  
 ၁၅၅၉  
 ၁၅၆၀  
 ၁၅၆၁  
 ၁၅၆၂  
 ၁၅၆၃  
 ၁၅၆၄  
 ၁၅၆၅  
 ၁၅၆၆  
 ၁၅၆၇  
 ၁၅၆၈  
 ၁၅၆၉  
 ၁၅၇၀  
 ၁၅၇၁  
 ၁၅၇၂  
 ၁၅၇၃  
 ၁၅၇၄  
 ၁၅၇၅  
 ၁၅၇၆  
 ၁၅၇၇  
 ၁၅၇၈  
 ၁၅၇၉  
 ၁၅၈၀  
 ၁၅၈၁  
 ၁၅၈၂  
 ၁၅၈၃  
 ၁၅၈၄  
 ၁၅၈၅  
 ၁၅၈၆  
 ၁၅၈၇  
 ၁၅၈၈  
 ၁၅၈၉  
 ၁၅၉၀  
 ၁၅၉၁  
 ၁၅၉၂  
 ၁၅၉၃  
 ၁၅၉၄  
 ၁၅၉၅  
 ၁၅၉၆  
 ၁၅၉၇  
 ၁၅၉၈  
 ၁၅၉၉  
 ၁၆၀၀



Handwritten text in a cursive script, likely a historical document or manuscript. The text is densely packed and spans the entire page. The script is highly stylized and difficult to decipher. The document appears to be a record or a list of items, possibly related to a military or administrative context, given the use of terms like "soldado" and "caballero" in some of the legible fragments. The text is written in a dark ink on aged, slightly yellowed paper. There are some faint markings and a large, faint watermark or stamp in the center of the page, which is partially obscured by the text. The overall appearance is that of an old, handwritten document.







Handwritten Burmese script, likely a historical document or manuscript. The text is written in a cursive style and covers the entire page. It appears to be a list or a series of entries, possibly related to a royal decree or administrative record. The script is dense and fills most of the page.







Handwritten Burmese script, likely a historical document or manuscript. The text is densely packed and written in a cursive style. It appears to be a list or a series of entries, possibly related to a royal decree or administrative record. The script is written in black ink on aged, slightly yellowed paper. There are some faint markings and what appears to be a watermark or stamp in the center of the page, but the text is the primary focus. The lines of text are somewhat irregular, following the natural flow of the writing. The overall appearance is that of an old, well-preserved document.







Handwritten text in a cursive script, likely a historical document or manuscript. The text is densely packed and spans the entire page. It appears to be a list or a series of entries, possibly related to a collection or inventory. The script is highly stylized and difficult to decipher without specialized knowledge of the language and script. The text is written in dark ink on aged, slightly yellowed paper. There are some faint markings and a small blue mark on the right side of the page.







Handwritten text in a cursive script, likely a historical document or manuscript. The text is densely packed and covers most of the page. It appears to be written in a language that may be related to the Burmese or Thai scripts, given the context of the page number and the style of the characters. The text is organized into several lines, with some lines starting with a small symbol or character. The overall appearance is that of a well-preserved but aged piece of paper.







Handwritten text in Khmer script, likely a manuscript or historical document. The text is densely packed and covers most of the page. It appears to be a list or a series of entries, possibly related to a historical record or a collection of names. The script is cursive and characteristic of traditional Khmer writing. There are some faint markings and what looks like a watermark or a large, light-colored mark in the center of the page, possibly a seal or a stamp, though it is not clearly legible. The text is written in black ink on aged, slightly yellowed paper.







Handwritten Burmese script, likely a historical document or manuscript. The text is densely packed and written in a cursive style. It appears to be a list or a series of entries, possibly related to a royal decree or administrative record. The script is written in black ink on aged, slightly yellowed paper. The text is arranged in approximately 25 horizontal lines, with some lines starting with a small circular symbol or initial. The overall appearance is that of a well-preserved but clearly aged historical document.







Handwritten Burmese script, likely a historical document or manuscript. The text is densely packed and written in a cursive style. It appears to be a list or a series of entries, possibly related to a military campaign or administrative record. The script is written in black ink on aged, slightly yellowed paper. The text is arranged in approximately 20 horizontal lines, with some lines containing multiple columns of text. The characters are small and closely spaced, characteristic of traditional Burmese handwriting. There are some faint markings and a large, light-colored smudge or stain in the lower right quadrant of the page, which partially obscures some of the text. The overall appearance is that of an old, well-used document.















Handwritten text in a cursive script, likely a historical document or manuscript. The text is densely packed and spans the entire page. The script is highly stylized and difficult to decipher without specialized knowledge of the language and script. The document appears to be a formal record or a legal document, given the structured nature of the entries and the use of certain symbols and flourishes. The text is written in dark ink on aged, slightly yellowed paper. There are some faint markings and a large, light-colored smudge or stain in the lower right quadrant of the page.







Handwritten Burmese script, likely a historical document or manuscript. The text is densely packed and written in a cursive style. It appears to be a list or a series of entries, possibly related to a royal decree or a historical record. The script is written in black ink on aged, slightly yellowed paper. The text is arranged in approximately 20 horizontal lines, with some lines containing multiple columns of writing. The overall appearance is that of a well-preserved but aged historical document.







Handwritten text in a cursive script, likely a historical document or manuscript. The text is densely packed and spans the entire page. It appears to be a list or a series of entries, possibly related to a legal or administrative record. The script is highly stylized and difficult to decipher without specialized knowledge of the language and script. The text is written in a dark ink on aged, slightly yellowed paper. There are some faint markings and a large, irregular green stain in the center of the page, which partially obscures some of the text. The overall appearance is that of an old, well-used document.







Handwritten text in a cursive script, likely a historical document or manuscript. The text is densely packed and covers most of the page. It appears to be a list or a series of entries, possibly related to a collection or inventory. The script is highly stylized and difficult to decipher without specialized knowledge of the language and script. The text is written in dark ink on aged, slightly yellowed paper. There are some faint markings and a large, irregular blue stain in the lower right quadrant of the page.







Handwritten text in Khmer script, likely a historical document or manuscript. The text is densely packed and covers most of the page. It appears to be a list or a series of entries, possibly related to land or administrative matters, given the repetitive nature of some phrases. The script is cursive and characteristic of traditional Khmer writing. There are some faint markings and a large, light-colored smudge or watermark in the center-right area of the page.







Handwritten Burmese script, likely a historical document or manuscript. The text is densely packed and written in a cursive style. A large, faint watermark is visible in the center of the page, partially obscuring the text. The watermark appears to be a circular emblem with Burmese characters inside. The document is written on aged, slightly yellowed paper.







Handwritten Burmese script, likely a religious or historical text, written in a cursive style. The text is arranged in approximately 25 horizontal lines across the page. The characters are dark and dense, with some variations in line spacing. A faint, semi-transparent watermark or logo is visible in the center-right portion of the page, partially overlapping the text. The paper appears aged and slightly yellowed.







Handwritten Burmese script, likely a historical document or manuscript. The text is densely packed and written in a cursive style. It appears to be a list or a series of entries, possibly related to a royal decree or administrative record. The script is written in black ink on aged, slightly yellowed paper. The text is arranged in approximately 15 horizontal lines, with some characters written in a larger, more decorative font, possibly indicating titles or important terms. The overall appearance is that of a well-preserved but clearly aged historical document.



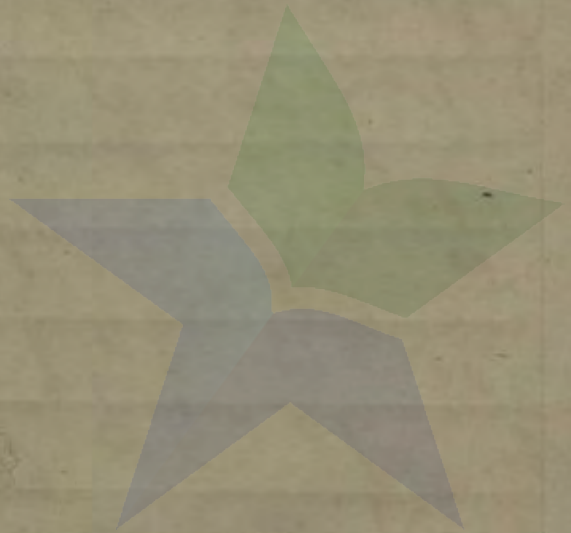



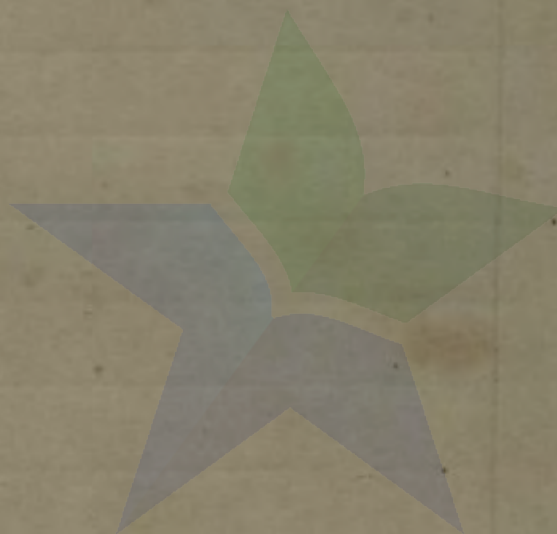



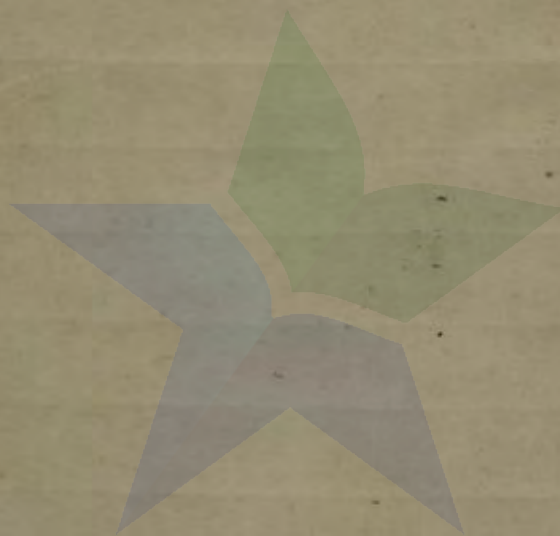



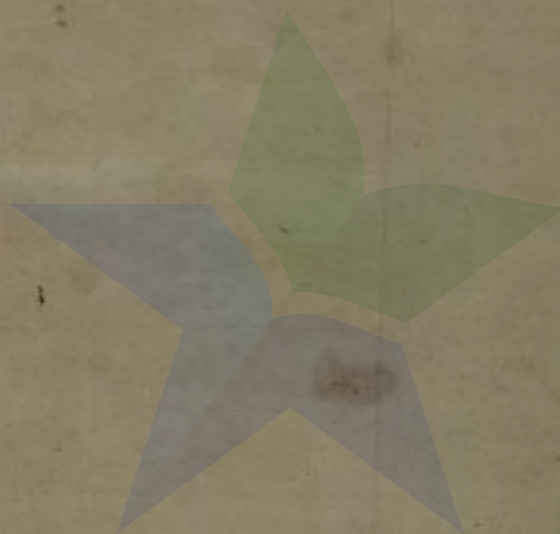



Handwritten text at the top of the page, possibly a title or header.



Handwritten text in the middle section, partially obscured by a watermark.

Handwritten text in the lower middle section, also partially obscured by a watermark.

Handwritten text at the bottom of the page, including what appears to be a signature or date.















